

M2000 SERIES GAS BROODERS

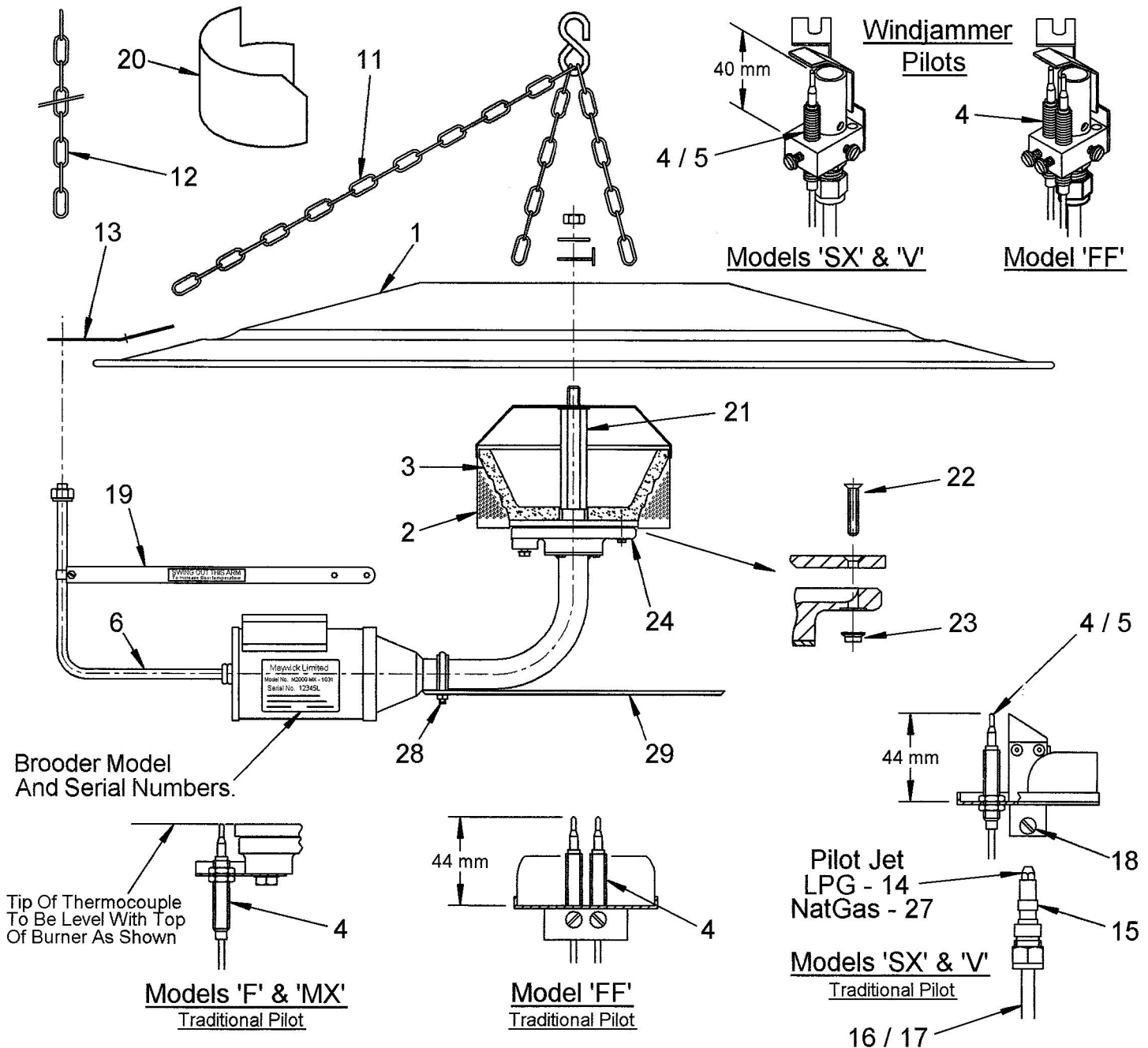

M2000 SPARE PARTS

No.	DESCRIPTION.	PART No.
1	Canopy - Aluminised Steel	6951
	- Aluminium - Wet Conditions (Ducks)	6933
2	Replacement Mantle	4204
3	Replacement Cone	6172
4	Thermocouple F / FF / MX & SX	6095
5	Thermocouple V Model Only	6299
6	Main Feed Assembly M20	3224
7	Main Injector	6423
8	Main Jet LPG - F / FF & V - No. 180	6020
9	Main Jet LPG - MX & SX - No. 200	6022
10	M5 Stainless Screw	7139
11	Suspension Kit M20	3073
12	2m Hanging Chain	6102
13	Canopy Edge Bracket	6049
14	Pilot Jet LPG - FF / V & SX - No. 8	6001
15	Pilot Injector - V & SX - Controls	6452
16	Pilot Feed Assy. - SX Control	3208
17	Pilot Feed Assy. - FF & V Control	3022
18	M4 Stainless Screw	7138

Main Jet
LPG - 8 / 9
NatGas - 25 / 26

19	Probe Bracket Assembly Long	3069
20	Pilot Air Baffle	3017
21	Cone Spacer	6780
22	Stainless Steel Countersunk Screw	7105
23	Stainless Steel Flange Nut	7106
24	Burner And Top Plate Assembly	6783
25	Main Jet NatGas - F / FF & V - No. 360	6030
26	Main Jet NatGas - MX & SX - No. 360	6030
27	Pilot Jet NatGas - FF / V & SX - No. 20	6232
28	'U' Clamp	6784
29	Spark Tray	4625